



SigniFlow V2026.0.1.4 Release notes.

12th February 2026

This document is confidential

New Features / Enhancements (SigniFlow) – Font End

- Improved reporting where document names that contain a “=” sign, does not appear in reports.
- Improved 2D face signing images to ensure that image is not stretched in certain browsers.
- Improved user experience on the new workflow engine where the minimum and maximum number fields for group checkboxes do not reflect the correct values when closing and opening the side panel after updating the amounts.

Checkbox Groupings (Mandatory)

	YES	NO
Clause 4 was explained to you by the representative	<input checked="" type="checkbox"/>	<input type="checkbox"/>
Clause 5 was explained to you by the representative	<input type="checkbox"/>	<input checked="" type="checkbox"/>
Clause 6 was explained to you by the representative	<input type="checkbox"/>	<input type="checkbox"/>

Policy Choices (Mandatory)
Please choose which policy you are interested in:

Company Name:

Registration Number:

All recipients receive an Email with a link to the document. Click on the link or simply watch as your SignFlow system pending folder updates with any new documents that require your attention.

Copy Remove

 Andre Minnaar
andrens@signiflow.com

> Position

> Dimension

∨ Validation

Min Max

1

1

- Improved “Sign All” functionality, where a user is now redirected to the completed page when accessing a workflow from the email notification.
- Improved bulk signing functionality to improve error handling on certain workflows with electronic signatures.
- Improved bulk signing functionality when group workflows are used.
- Improved the system where the recipient colors don’t update correctly in certain cases.
- Improved general layout inconsistencies in the new workflow engine.
- Enhanced functionality on electronic signatures to display the name, date or signed.



- Enhanced error handling to address an issue where duplicate users can be added as a Report Manager.
- Made changes to the “Next Action” button in EasiSign to state “No Action Required” when the user does not have anything to action on the document.
- Launched new SharePoint plugin.
- Added the ability to load multiple SharePoint configurations per business.
- Added tooltips on all grids for document names that are too long to display.
- Added SINGPASS login as a login provider.
- Added the ability to upload multiple personal stamps in your profile. The user will be able to select which one to use when stamping a document.

Personal Stamps ✕

Please select one of the stamps that you have uploaded and saved in your profile, alternatively if you would like a different one please upload one from your local machine.



?

?

?

?

Drag stamp file here.

The accepted formats are : jpeg, bmp, png

Maximum file size of 500KB

Click to upload your stamp file.

Cancel

- Added the ability to capture “additional data” on a document in the new workflow engine.



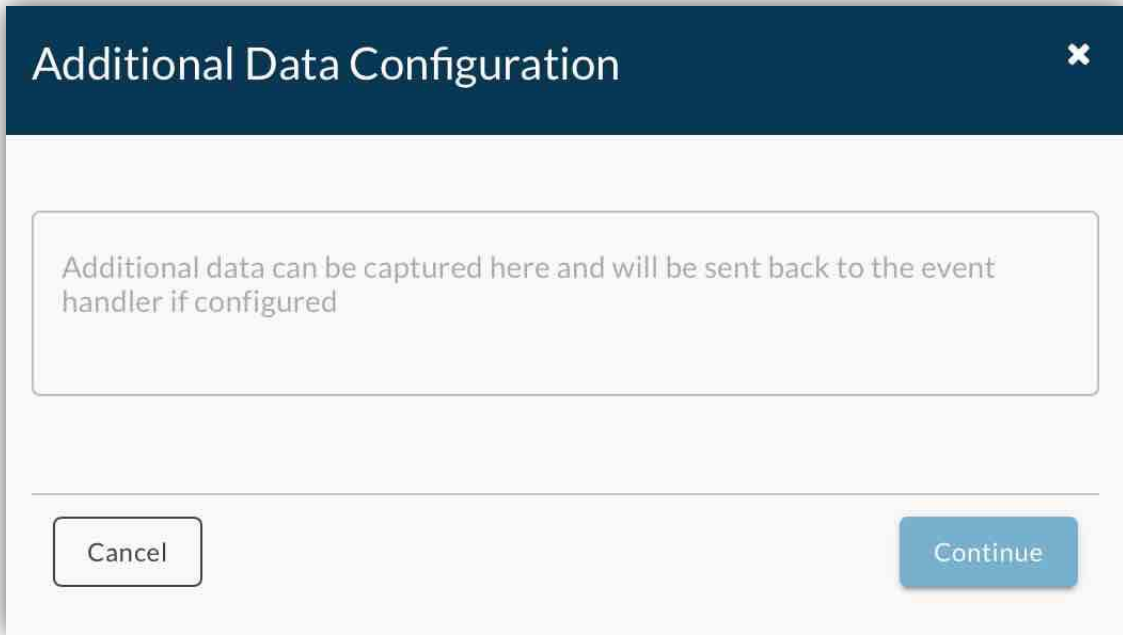

- Added the functionality to have the document link sent out via SMS from the new workflow engine.

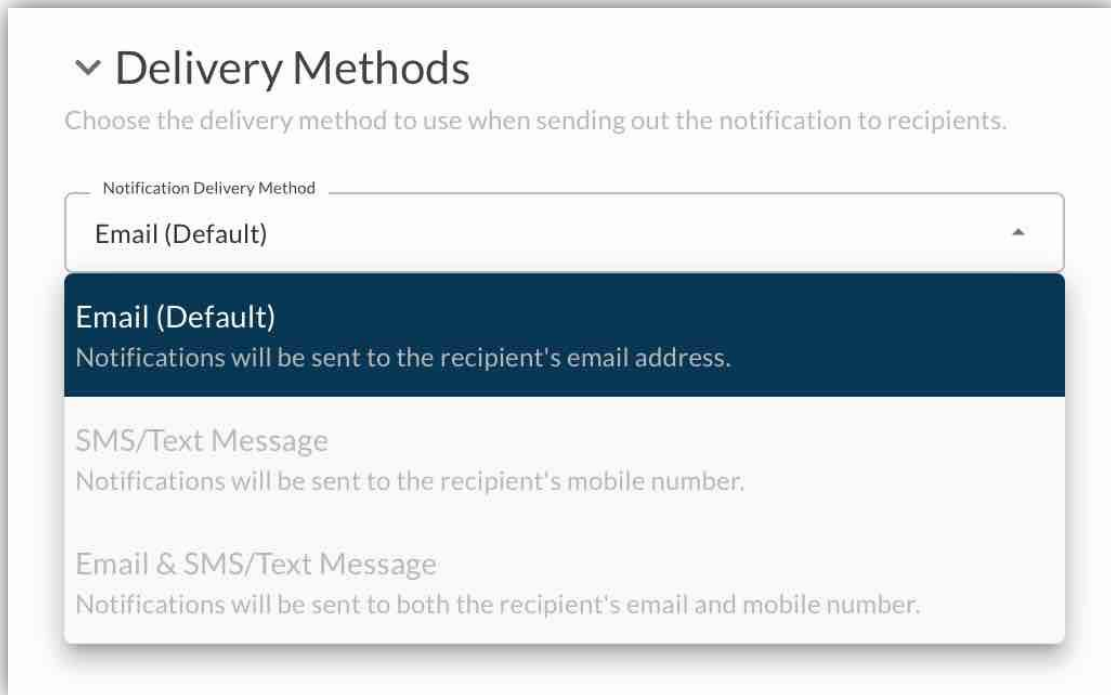

- Removed the version banner from the signature image on the new workflow interface dashboard.



- Added the ability to search for workflow templates on the list that appears in the new workflow interface.

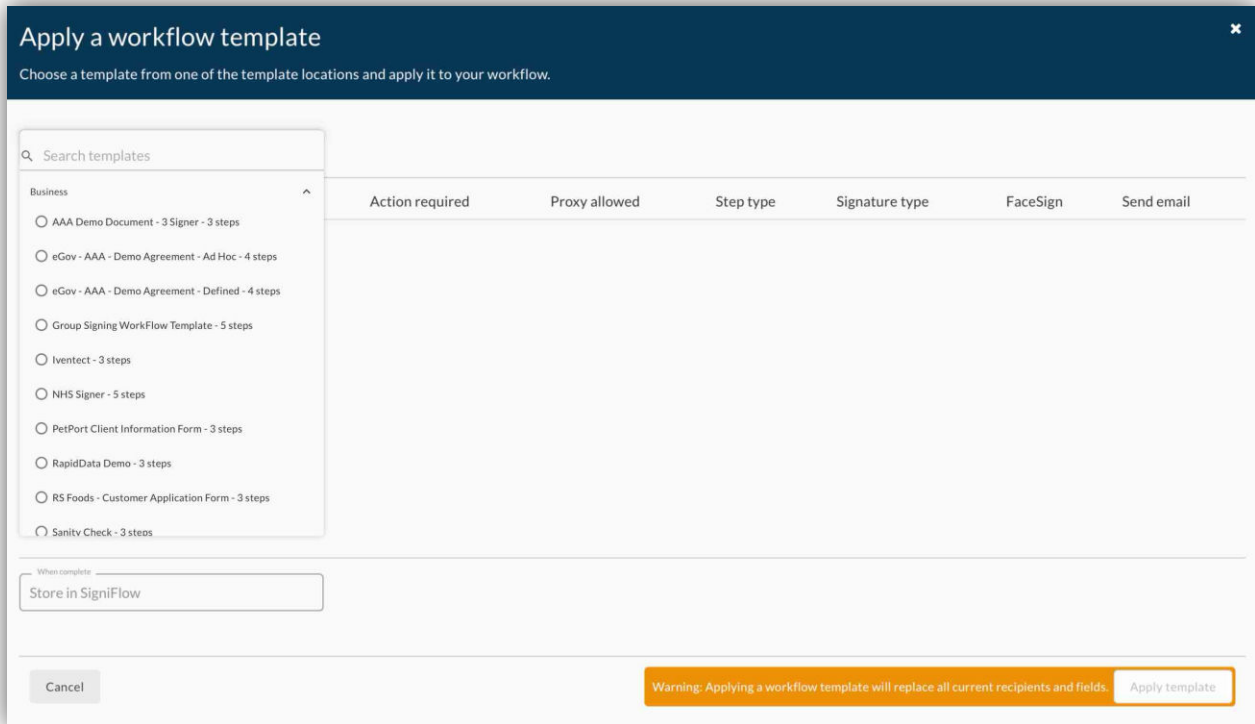

- Changed the workflow template sorting to be alphabetically instead of sorting it by created date.
- Added additional security to the “Draw on Mobile” QR code that is generated on the signature setup page.
- Added the ability to receive the OTP on email and not just mobile.
 - The setting can also be changed to send to both email and mobile at the same time.
- Improved the Office 365 add ins to support different SSO providers configured on SigniFlow.

New Features / Enhancements (SigniFlow) – General System Improvements

- Improved reporting error handling to ensure an empty email address cannot be added as a Report Manager.
- Improved email notifications where rejected document emails are not sent out in certain scenarios.
- Improved email notifications where workflow cancellation emails are sent out for completed documents when a portfolio is deleted.
- Aligned translations within the system.
- Updated FaceTec version for better verification on liveness processes.
- Removed the old notifications page.
- Improved international mobile number validation on the different registration pages.
- Made changes to the “Portfolio Completed Email” rule to allow for different default states and forced states that can be set from the business settings page.
- Made changes to the upload process to chunk documents during upload for better processing on larger documents.
- Made change to how images are used for initials on the document, to reduce the final size of the document when multiple initials are added.
- Added the “CreatedDate” property for the DocPrepperGetAllFields API call.
- Implemented the “Force Custom Message” rule on the new workflow interface.

- Implemented the “Disable Download” rule on the new workflow interface.
- Implemented the “Disable Delete” rule on the new workflow interface.
- Added the ability to load predefined face-to-face signers to a group signer through the FullWorkflow API.
- Increase document upload to 10 documents to be uploaded at a time.
- Aligned auto tagging placement between front end and API.

Fixes/Bug Fixes (SigniFlow)

- Fixed an issue where the forms page does not work when the user language is on either French or Afrikaans.
- Fixed an issue where all SAML authentication provider buttons are visible when configuration is loaded for one of them.
- Fixed an issue where business language defaults are not applied correctly in the new workflow engine.
- Fixed an issue where the mobile number field for the signer’s proxy does not clear when the clear button is clicked.
- Fixed an issue where the document name overlaps with the action buttons during document prepping. If documents have a long name the action buttons are moved into the sub menu inside the 3 dots.
- Fixed an issue on “Sign All” and group workflows where the same user could sign on multiple fields in a group signing workflow when Sign All is used.
- Fixed an issue that could prevent documents from being removed out of the delete grid in certain scenarios.
- Fixed an issue where the document audits fail to generate if the setting to show initials on audit logs are enabled and the workflow contained a predefined face-to-face signer.
- Fixed an issue on the classic dashboard that prevented users from sorting documents on the completed date.
- Fixed an issue that allowed duplicate viewers to be added to a workflow.
- Fixed an issue where mandatory fields that are disabled due to conditional fields, are still being validated and prevent signing from continuing unless filled in.
- Fixed an issue where documents with a certain length name failed to sign when using LawTrust as the certificate provider for signing.
- Fixed an issue where viewer only workflows show their progress as 1 of 0 and do not get updated to completed.
- Fixed an issue where the Shared Key text field does not appear during document prepping even when your EasiSign configuration is set to make use of Shared Key.
- Fixed an issue on classic workflow where the “SendCompletedEmail” value in the grid displays both Yes and No, instead of the selected value.
- Fixed an issue where duplicate users can be added as a Form Admin.
- Fixed an issue where empty an email address can be added as a Form Admin.
- Fixed an issue where duplicate users can be added as a Template Admin.
- Fixed an issue where empty an email address can be added as a Template Admin.
- Fixed a bug on classic dashboard where if a user toggles to the new interface while in a basket, the basket page reloads with no data, and the user must go back to dashboard to see the new interface.
- Fixed an issue where portfolio settings would not save correctly in some instances during document prepping.
- Fixed an issue where documents lose their .pdf extension during download if the name of the document contained a semicolon.

- Fixed an issue that prevented users from signing and opening documents when the name of the account contained double quotes.
- Fixed an issue where user accounts could lose their license by signing into multiple different servers that they have used in the past prior to having a license on their account, which causes an incorrect sync to happen and removing the user from their existing license.
- Fixed an issue for auto tagged documents containing tags for predefine face-to-face signers, where the face-to-face signer gets assigned to the wrong account in some cases during workflow creation from the new workflow interface.
- Fixed an issue that prevented users to approve documents when no signature has been set on their profile.
- Fixed the DocPrepperGetAllFields API call that fails when a workflow contains group signers and the workflow has not yet been completed.
- Fixed an issue on the new workflow interface where document workflows tagged as high priority are not correctly updated and subsequently the email that goes out is not flagged as high priority.
- Made changes to prevent users from sending multiple reminders for the same document.
- Fixed an issue on email reminders where if no due date is set for the document, the reminder emails fail to send out.
- Fixed an issue where users cannot access a portfolio when a portfolio is shared with them in some cases due to the document level access not being aligned.
- Fixed an issue on conditional fields where not all checkboxes are being hidden when the required condition is not met.
- Fixed an issue that prevented users from disabling the portfolio notifications from the portfolio page.
- Fixed an issue where some fields appear rotated on the document due to different origin settings on the uploaded document.
- Fixed an issue on the new workflow interface where “Receives a copy” toggle is still selectable if when the “Disable Email Company Wide” rule is enabled.

Document Information

Forward-Looking Statements

This document may contain forward-looking statements based on management's current beliefs, assumptions, and available information. These statements involve substantial risks and uncertainties.

Forward-looking statements include all statements that are not historical facts and may be identified by terms such as "may," "will," "should," "expects," "plans," "anticipates," "could," "intends," "target," "projects," "contemplates," "believes," "estimates," "predicts," "potential," "continue," "forward projection," "around," "considered," or "conservative," or the negative of such terms or similar expressions.

Actual results may differ materially from those expressed or implied in such statements due to various risks and uncertainties.

Confidential Classification

All rights reserved, including partial reproduction, photomechanical duplication (including microcopy), and analysis by database or related equipment.

This document and the information contained herein are proprietary to SigniFlow. Any information gained through use, viewing, reading, or otherwise becoming aware of its contents must be treated as confidential. No person may disclose, publish, or use this confidential information for personal or third-party benefit, or create derivative works thereof, except for purposes agreed to in writing by SigniFlow.

Document Classification

This document is restricted to recipients to whom SigniFlow has distributed it.

Document Contact

support@signiflow.com

Released 2026 – SigniFlow updated branding to SigniFlow.